

# Agenda

- Rückblick Markus
- Herausforderungen Sprintkarte Fritz
- IOF – Neuerungen Sprint Norm in Diskussion Martin
- Waldkarten «renovieren» Beat
- Waldkarte mit Tablett – Erfahrungen Hubert
- Kartentool & oMapCH Camilla & Fritz
- Produktenevents OCAD & MapAnt Gian-Reto
- **Effizientes Arbeiten mit Short Cuts** Martin
- Wald Diverses Gian-Reto
- Ausblick 2022 Markus

# Wege der Verbesserung der Zeicheneffizienz

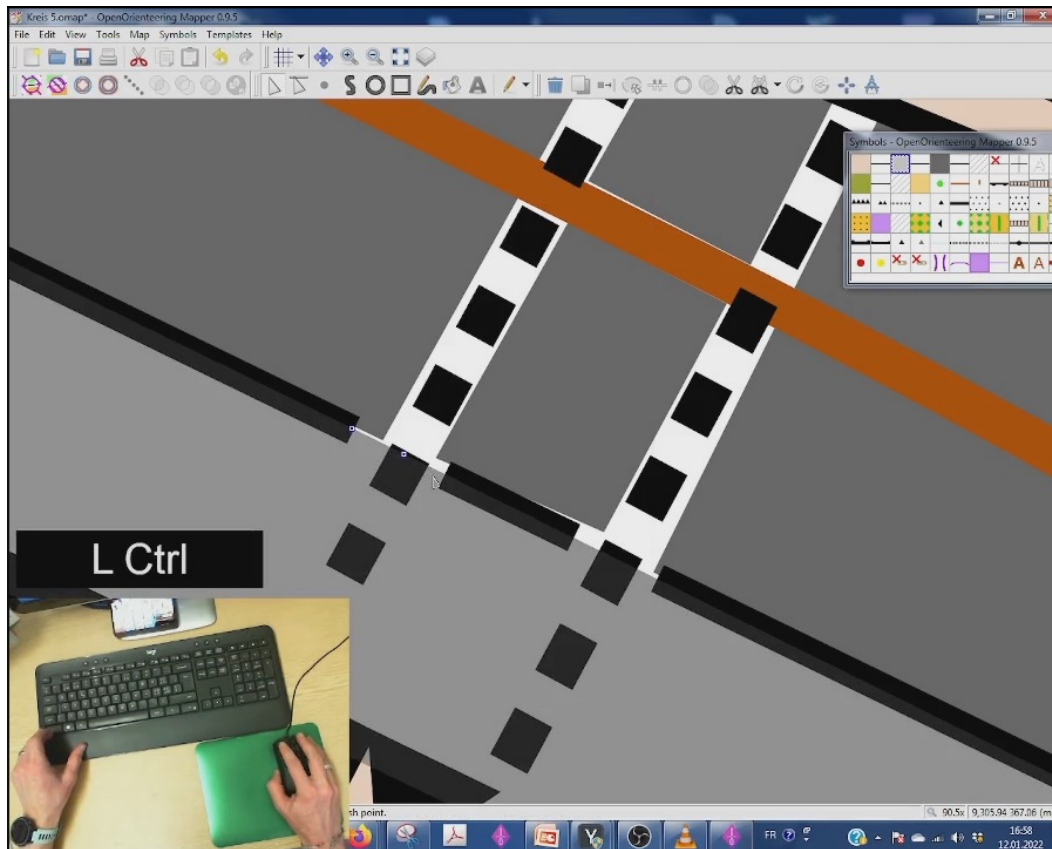

Screenshot ml

# Wege der Verbesserung der Zeicheneffizienz

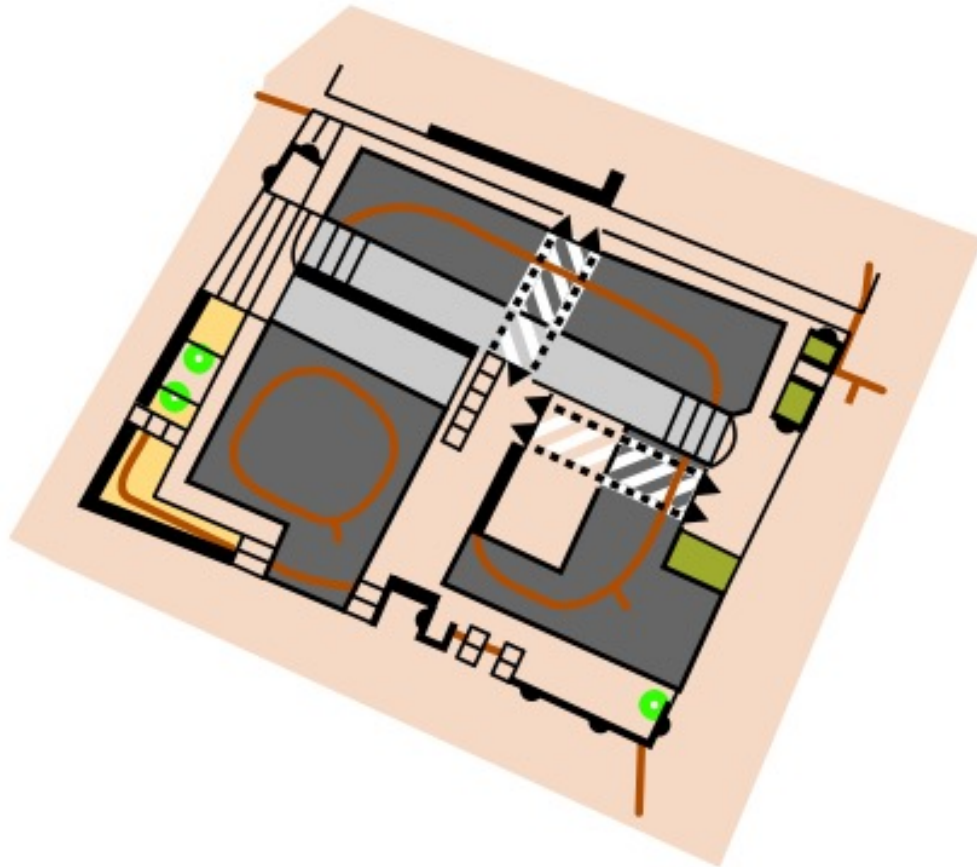

Screenshot ml

# Zeicheneffizienz Hilfe der Tastatur

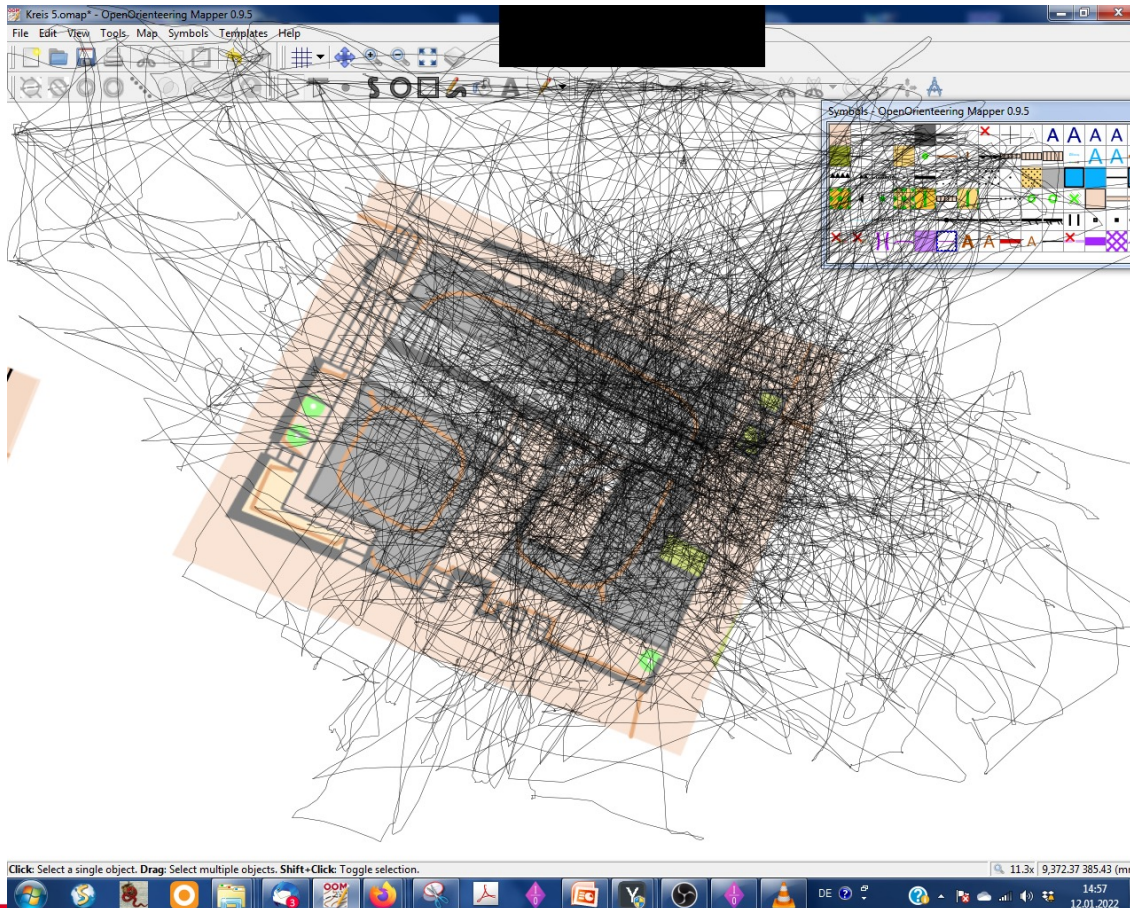

Mauspfade nur Maus

# Suchbewegungen

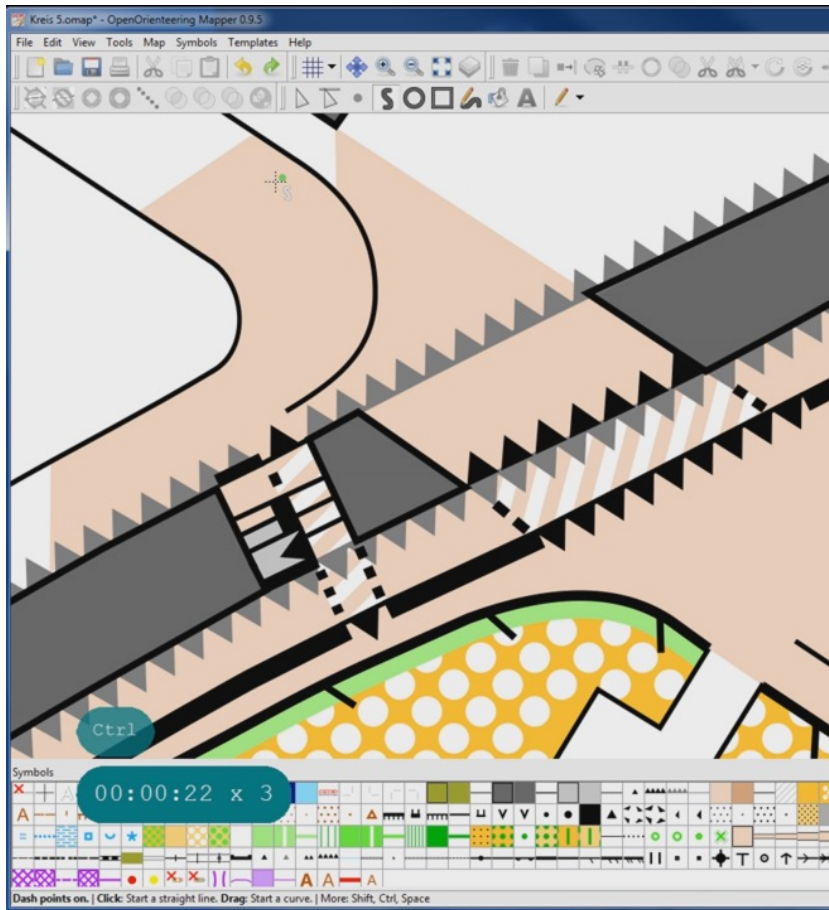

<https://youtu.be/Q2V-cd3owkg>

Video

**sw/SS**  
orienteering

# Kontext-Menu

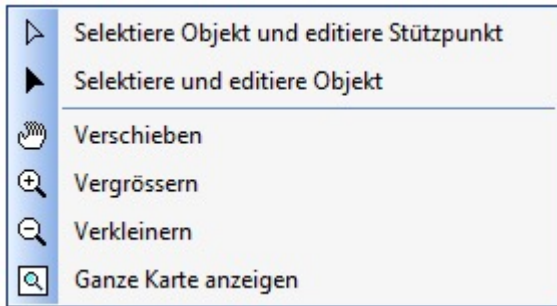

# Symbolleisten

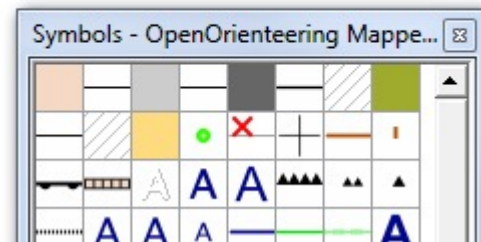
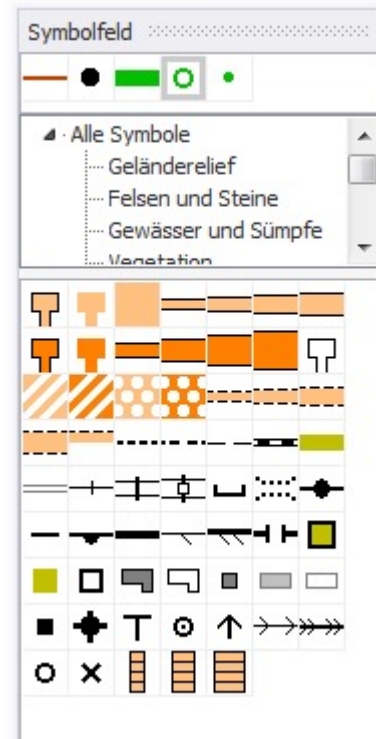

# Tastatur

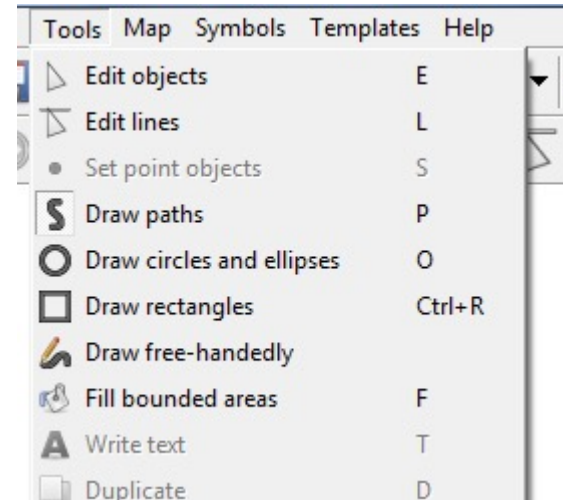
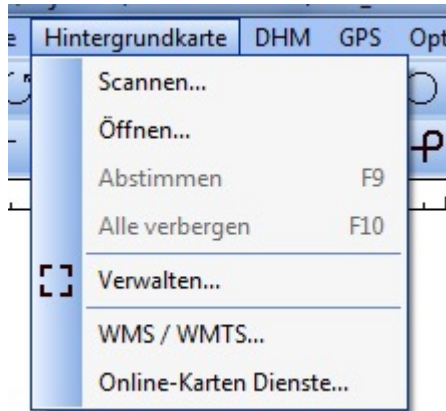



# Optimierte Zeichnung

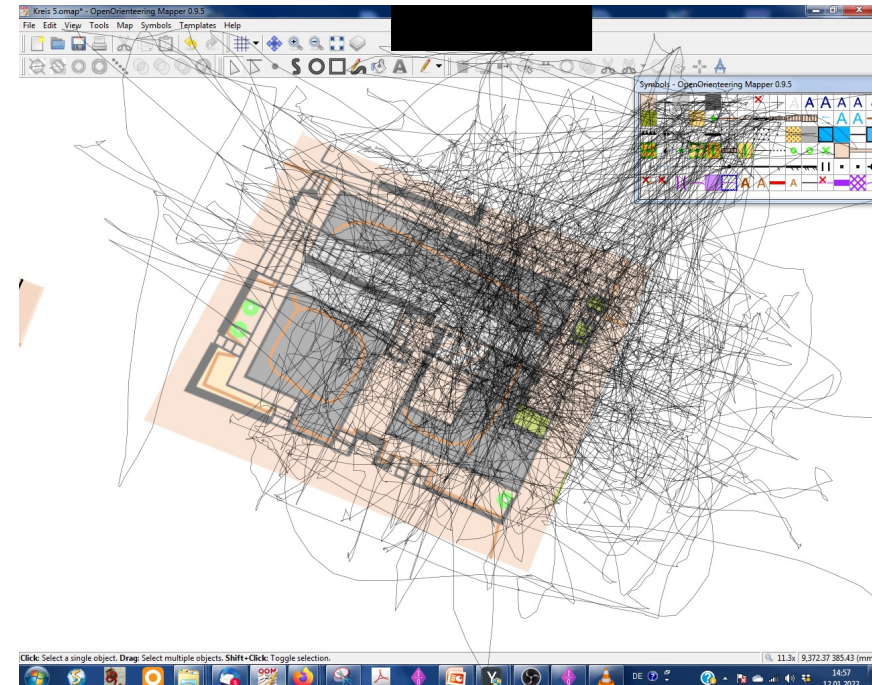
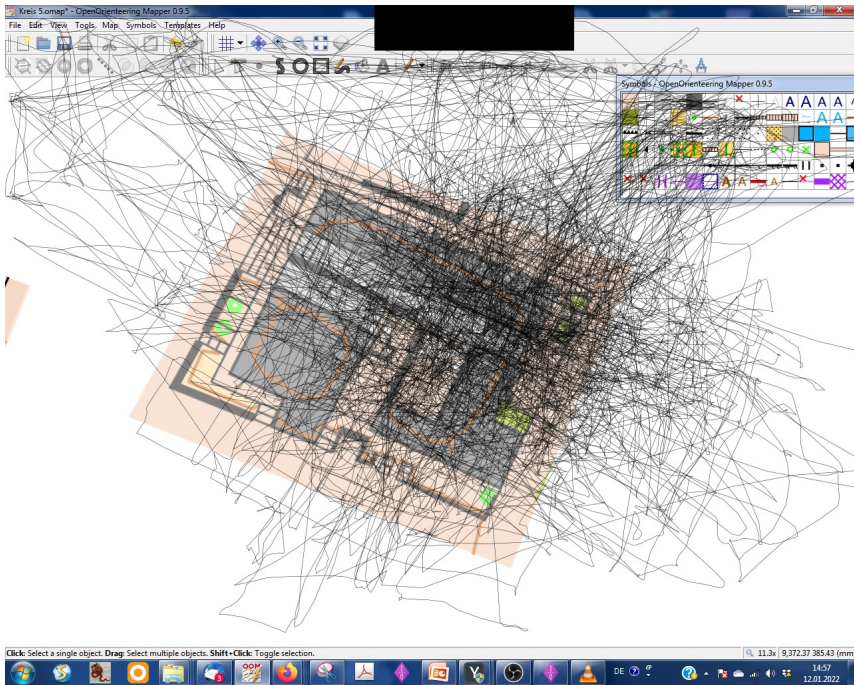

Symbolleisten

# Anordnen der shortcuts

**OCAD**<sup>+</sup>

the smart software  
for cartography

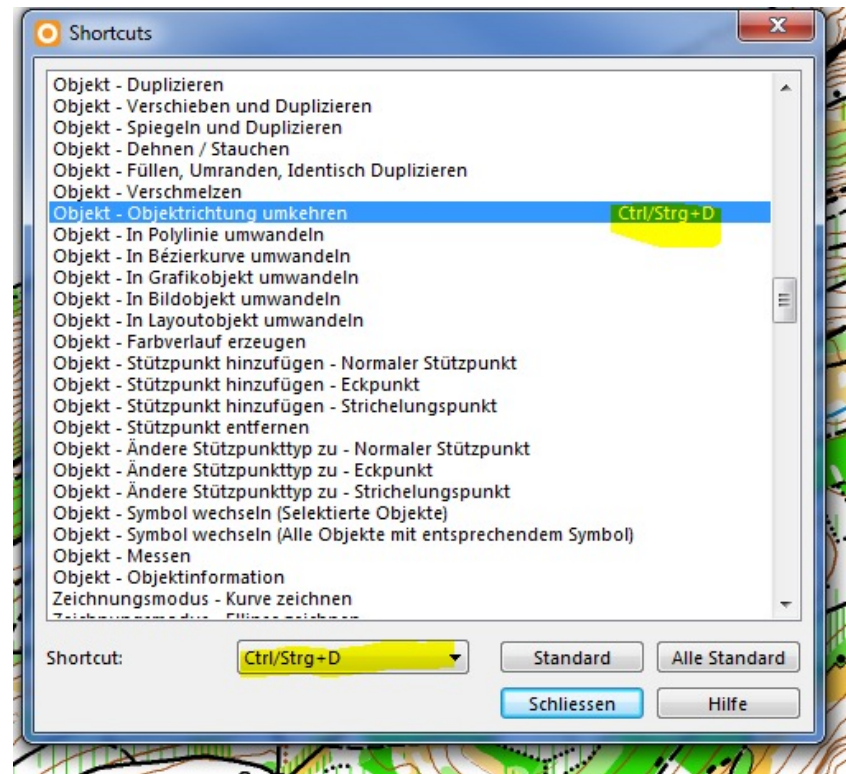
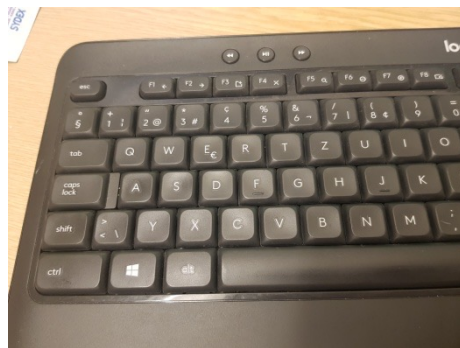
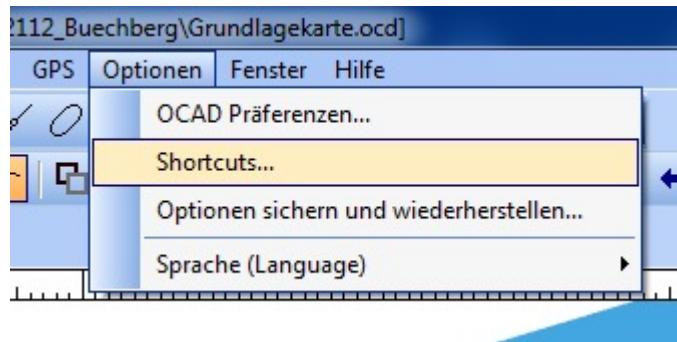

Shortcuts selbst definieren

**swiss**  
orientering

# Weitere Optimierung



## Mapper Keypad



Frei belegbares Keypad

# Weitere Optimierung



## Mapper Keypad

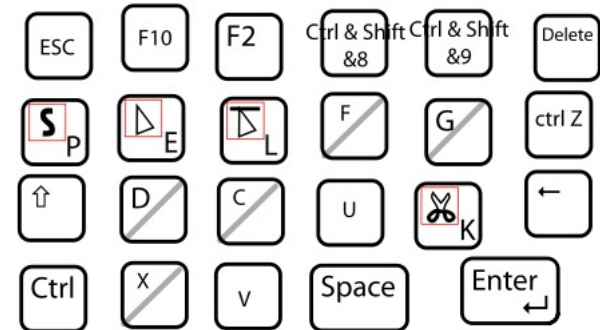
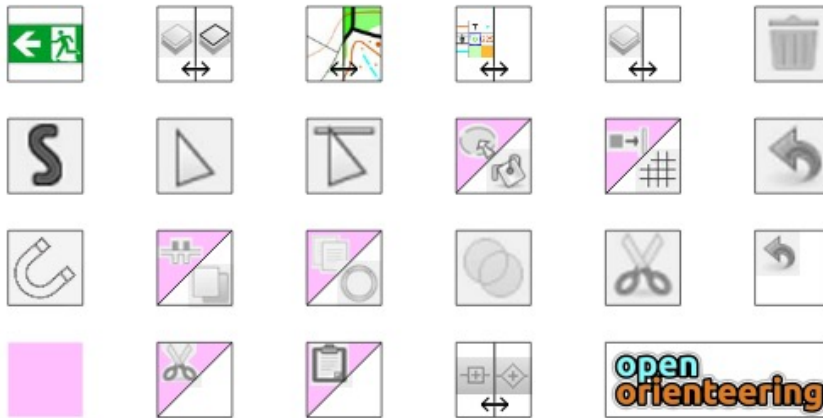

# Zeichnen mit Mapper Keypad

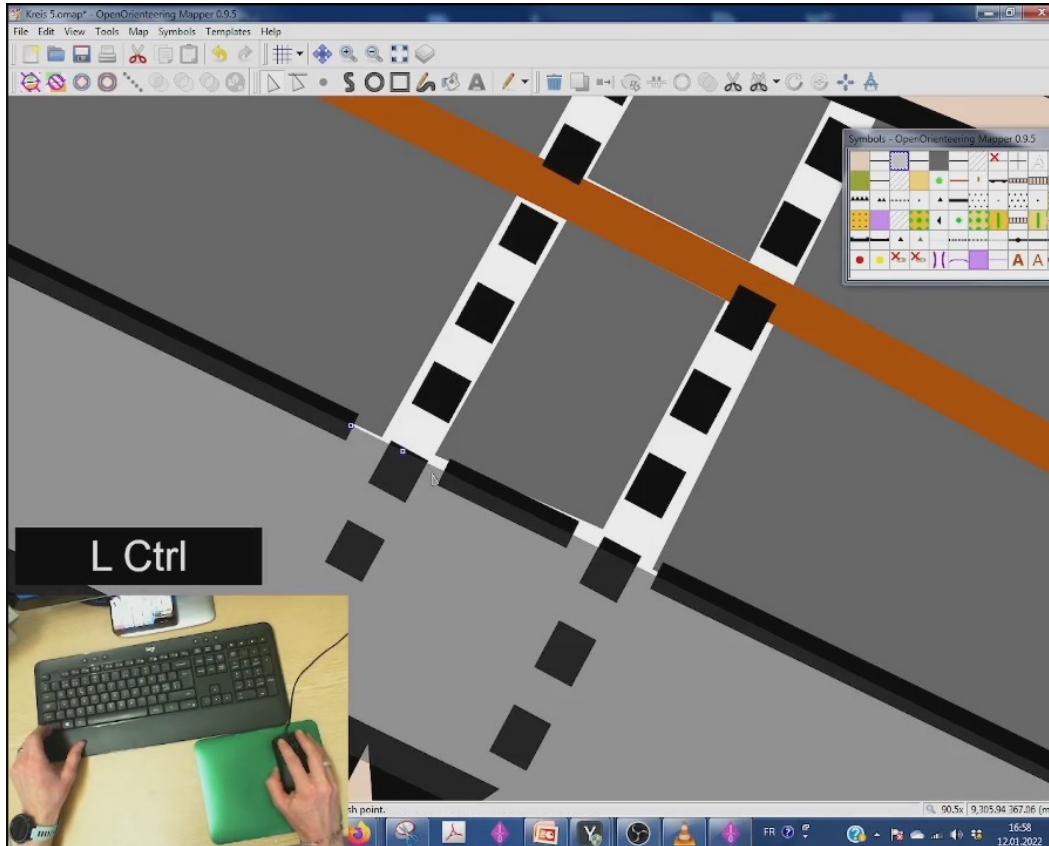

<https://youtu.be/Ns47GFhYJzI>

# keyboard vs. keypad

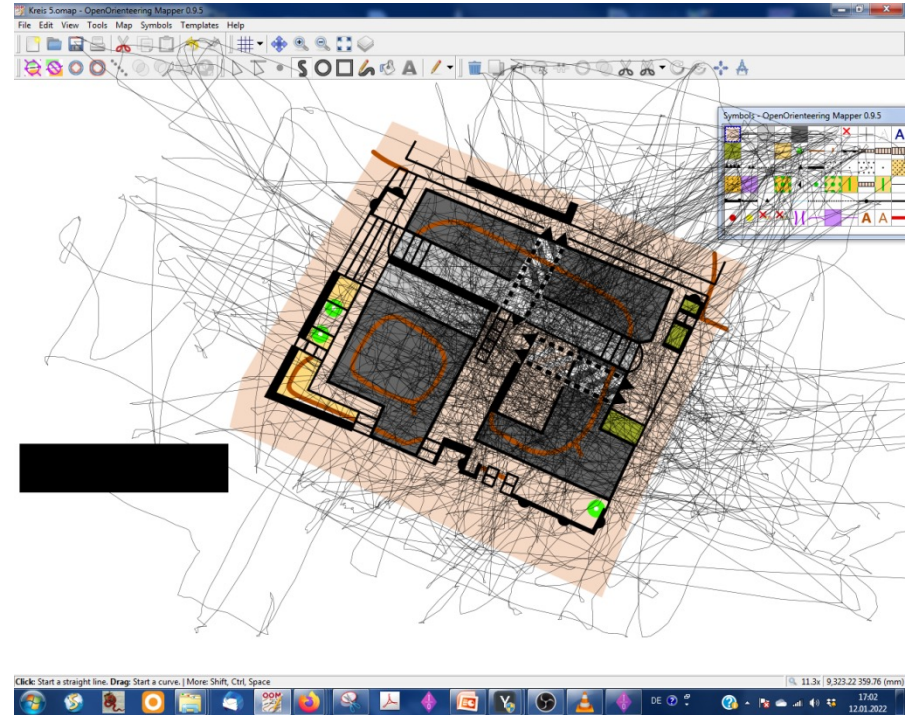
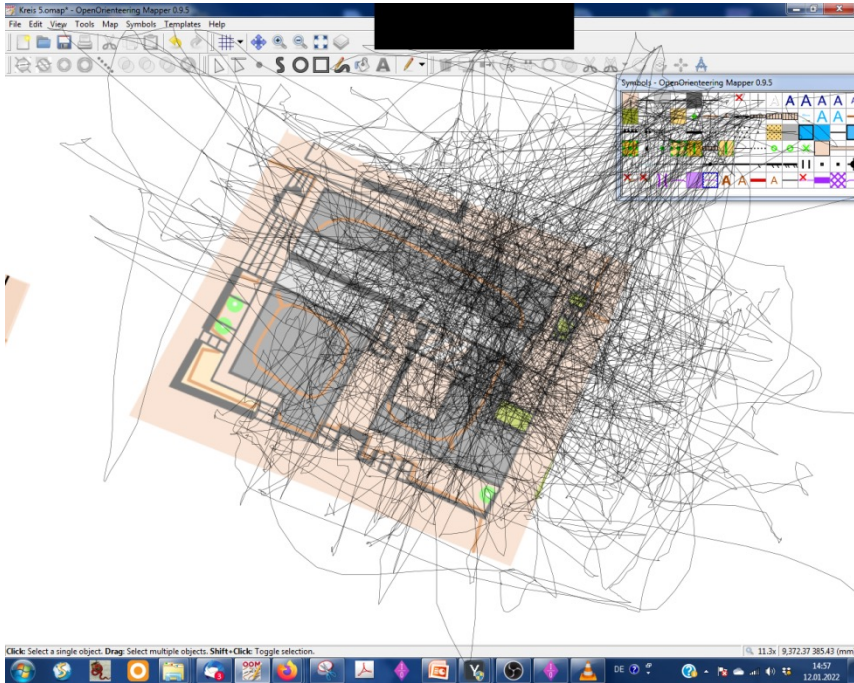

# Nur Maus vs. optimierte Zeichnung

